

# FOUNTAIN NOZZLES 20/01

## FOUNTAINS

### DESIGN AQUA 01

#### ✓ Technical features

- Water dancing fountain for indoor and outdoor use
- RGB, white and warm white fountain lights
- Iron or AISI-304 stainless steel submersible pump
- AISI-304 stainless steel fountain nozzle
- Voltage: 110-220V 50/60Hz
- Cable: IEC standard
- Optional controller

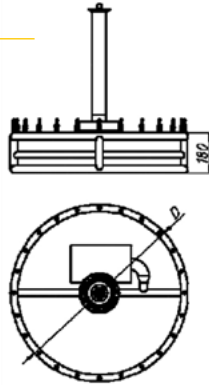

#### 🔍 Models

PRODUCT CODE	AQ01-680	AQ01-800	AQ01-1000
BODY DIAMETER 'D'	68 cm	80 cm	100 cm
PUMP POWER	130 watts	155 watts	170 watts
WATER HEIGHT	0.7-0.9 m	0.7-1.1 m	0.7-1.3 m
WATER COVER DIAMETER	0.7 m	0.9 m	1.1 m
PACKING SIZE	72 x 72 x 24 cm	84 x 84 x 24 cm	104 x 104 x 25 cm
GROSS WEIGHT	10 kg	12 kg	15 kg

### DESIGN AQUA 02

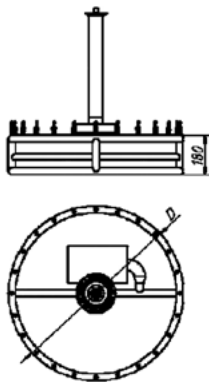

#### 🔍 Models

PRODUCT CODE	AQ02-680	AQ02-800	AQ02-1000
BODY DIAMETER 'D'	68 cm	80 cm	100 cm
PUMP POWER	130 watts	155 watts	170 watts
WATER HEIGHT	0.4 m	0.5 m	0.6 m
WATER COVER DIAMETER	0.7 m	0.9 m	1.1 m
PACKING SIZE	72 x 72 x 24 cm	84 x 84 x 24 cm	104 x 104 x 25 cm
GROSS WEIGHT	10 kg	12 kg	15 kg

# FOUNTAIN NOZZLES 20/01

## FOUNTAINS

### DESIGN AQUA 03

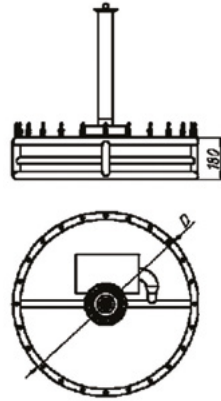

#### Models

PRODUCT CODE	AQ03-680	AQ03-800	AQ03-1000
BODY DIAMETER 'D'	68 cm	80 cm	100 cm
PUMP POWER	130 watts	155 watts	170 watts
WATER HEIGHT	0.6 m	0.7 m	0.8 m
WATER COVER DIAMETER	0.9 m	1 meter	1.2 m
PACKING SIZE	72 x 72 x 24 cm	84 x 84 x 24 cm	104 x 104 x 25 cm
GROSS WEIGHT	10 kg	12 kg	15 kg

### DESIGN AQUA 04

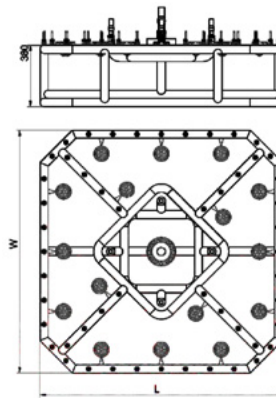

#### Models

PRODUCT CODE	AQ04-1000	AQ04-1200	AQ04-1500
BODY SIZE L x W	60 x 60 cm	80 x 80 cm	100 x 100 cm
PUMP POWER	800 watts	110 watts	1500 watts
WATER HEIGHT	2 m	4 m	6 m
WATER COVER DIAMETER	1.2 m	1.8 m	3.0 m
PACKING SIZE	104 x 104 x 42 cm	124 x 124 x 42 cm	154 x 154 x 42 cm
GROSS WEIGHT	40 kg	45 kg	55 kg

# FOUNTAIN NOZZLES 20/01

## FOUNTAINS

### DESIGN AQUA 05

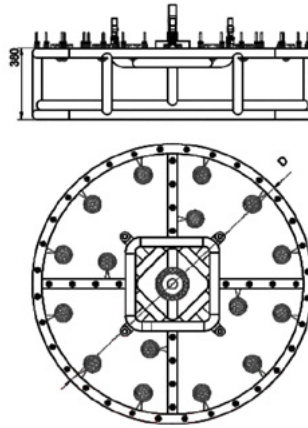

#### Models

PRODUCT CODE	AQ05-1000	AQ05-1200	AQ05-1500	AQ05-2000	AQ05-2500
BODY Ø 'D'	1 m	1.2 m	1.5 m	2 m	2.5 m
PUMP POWER	0.8 kW	1.1 kW	1.5 kW	2.2 kW	3 kW
WATER HEIGHT	2 m	4 m	6 m	8 m	10 m
WATER COVER	Ø 1.2 m	Ø 1.8 m	Ø 3.0	Ø 5.0	Ø 7.0
PACKING SIZE	104 x 104 x 42 cm	124 x 124 x 42 cm	154 x 154 x 42 cm	204 x 204 x 42 cm	254 x 254 x 42 cm
GROSS WEIGHT	40 kg	45 kg	55 kg	110 kg	155 kg

### DESIGN AQUA 06

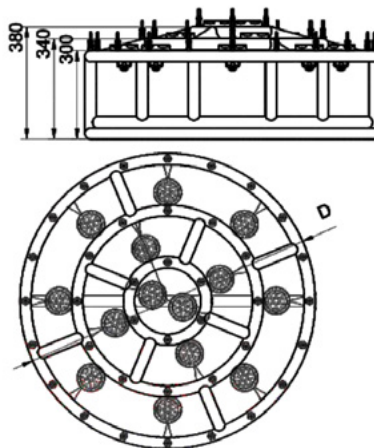

#### Models

PRODUCT CODE	AQ06-800	AQ06-1000	AQ06-1200	AQ06-1500
BODY DIAMETER 'D'	0.8 m	1 m	1.2 m	1.5 m
PUMP POWER	0.8 kW	1.1 kW	1.5 kW	2.2 kW
WATER HEIGHT	2 m	2.5 m	4.8 m	2.5 m
WATER COVER	Ø 1.2 m	Ø 1.5 m	Ø 1.8 m	Ø 2.5 m
PACKING SIZE	84 x 84 x 42 cm	104 x 104 x 42 cm	124 x 124 x 42 cm	154 x 154 x 42 cm
GROSS WEIGHT	40 kg	75 kg	85 kg	115 kg

# FOUNTAIN NOZZLES 20/01

## FOUNTAINS

### DESIGN AQUA 07

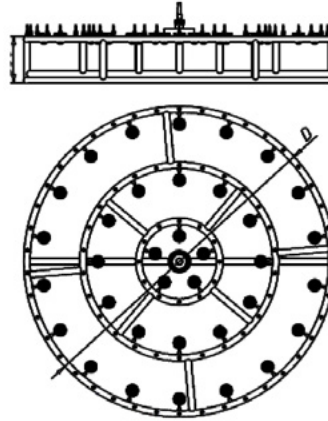
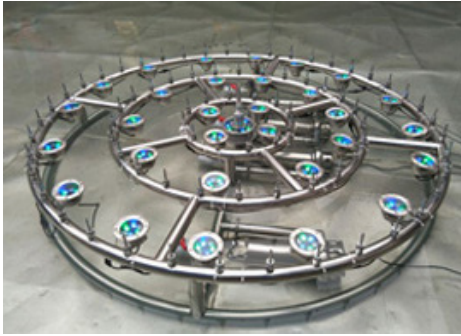

#### Models

PRODUCT CODE	AQ07-680	AQ07-800	AQ07-1000
BODY DIAMETER 'D'	68 cm	80 cm	100 cm
PUMP POWER	130 watts	155 watts	170 watts
WATER HEIGHT	0.6 m	0.7 m	0.8 m
WATER COVER DIAMETER	0.9 m	1 meter	1.2 m
PACKING SIZE	72 x 72 x 24 cm	84 x 84 x 24 cm	104 x 104 x 25 cm
GROSS WEIGHT	10 kg	12 kg	15 kg

### DESIGN AQUA 08

#### Models

CODE	AQ08-4020
BODY SIZE	400 x 200 cm
PUMP POWER	2 x 1.5 kW
WATER HEIGHT	1 m
LED LIGHTS	48 pcs
ADJUSTABLE NOZZLES	120 psc
MUSHROOM NOZZLES	4 pcs
SUBMESIBLE PUMPS	2 pcs
ELECTRICAL VALVE	4 pcs
PACKING SIZE	404 x 204 x 42 cm
GROSS WEIGHT	450 kg

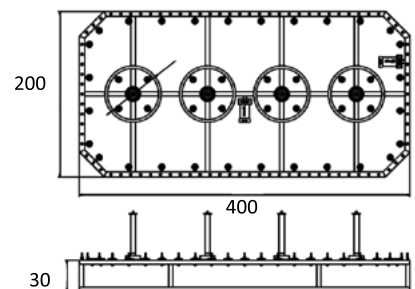

# FOUNTAIN NOZZLES 20/01

## FOUNTAINS

### DESIGN AQUA 09

#### Q Models

PRODUCT CODE	AQ09-4020
BODY SIZE	400 x 200 cm
PUMP POWER	3 x 1.5 kW
WATER HEIGHT	7 m
LED LIGHTS	72 pcs
ADJUSTABLE NOZZLES	114 psc
MUSHROOM NOZZLES	1 pcs
SUBMESIBLE PUMPS	3 pcs
ELECTRICAL VALVE	12 pcs
BALL VALVE	15 pcs
PACKING SIZE	404 x 204 x 42 cm
GROSS WEIGHT	480 kg

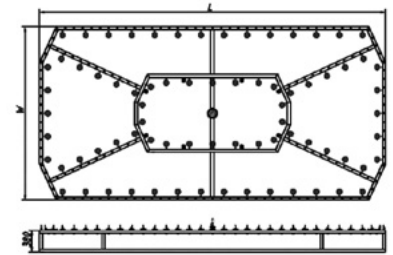

### DESIGN AQUA 10

#### Q Models

PRODUCT CODE	AQ10-4020
BODY SIZE	400 x 200 cm
PUMP POWER	5 x 1.1 kW
WATER HEIGHT	5 m
LED LIGHTS	66 pcs
ADJUSTABLE NOZZLES	174 psc
JADE CHOPSTICK NOZZLES	5 pcs
SUBMESIBLE PUMPS	5 pcs
ELECTRICAL VALVE	4 pcs
PACKING SIZE	404 x 204 x 42 cm
GROSS WEIGHT	480 kg

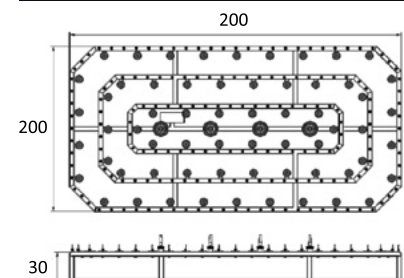

# FOUNTAIN NOZZLES 20/01

## FOUNTAINS

### DESIGN AQUA 11

#### Models

PRODUCT CODE	AQ11-4020	AQ11-5020	AQ11-8025
BODY SIZE	400 x 200 cm	500 x 200 cm	800 x 250 cm
PUMP POWER	8 x 1.1 kW	8 x 1.1 kW	8 x 1.5 kW
WATER HEIGHT	5 m	5 m	7 m
LED LIGHTS	37 pcs	47 pcs	94 pcs
ADJUSTABLE NOZZLES	36 pcs	40 pcs	88 pcs
FAN SHAPE NOZZLE	8 pcs	8 pcs	18 pcs
AIR IN NOZZLE	16 pcs	22 pcs	20 pcs
1.5" ADJUSTABLE	5 pcs	7 pcs	13 pcs
SUBMERSIBLE PUMPS	8 pcs	8 pcs	8 pcs
ELECTRICAL VALVE	8 pcs	8 pcs	8 pcs
PACKING SIZE	404 x 204 x 42 cm	504 x 204 x 42 cm	404 x 204 x 42 cm
GROSS WEIGHT	490 kg	650 kg	680 kg

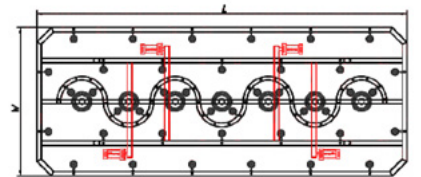

### DESIGN AQUA 12

#### Models

PRODUCT CODE	AQ12-4020	AQ12-5020
BODY DIAMETER "D"	5 m	7 m
PUMP POWER	10 x 1.1 kW	10 x 1.1 kW
WATER HEIGHT	10 m	10 m
LED LIGHTS	63 pcs	81 pcs
"1/2" ADJUSTABLE NOZZLES	60 pcs	80 pcs
"1" ADJUSTABLE NOZZLES	40 pcs	72 pcs
TOWER CEDAR NOZZLES	8 pcs	8 pcs
SUBMERSIBLE PUMPS	10 pcs	10 pcs
ELECTRICAL VALVE	10 pcs	10 pcs
PACKING SIZE	500 x 500 x 50 cm	700 x 700 x 50 cm
GROSS WEIGHT	500 kg	600 kg

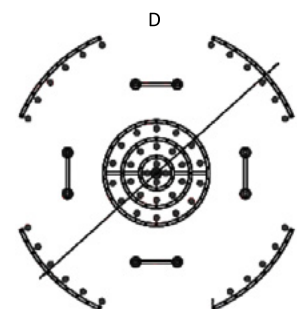
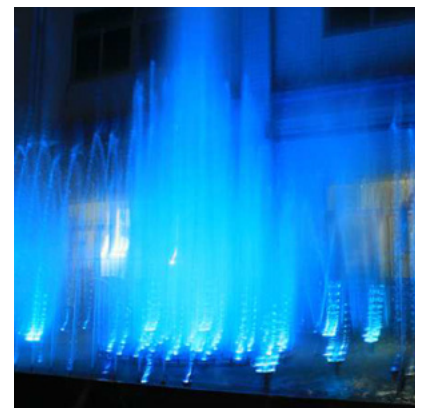

# FOUNTAIN NOZZLES 20/01

## FOUNTAINS

### DESIGN AQUA 13

#### Q Models

PRODUCT CODE	AQ13-2000
BODY DIAMETER	2 m
PUMP POWER	2 x 1.5 kW
WATER HEIGHT	4 m
LED LIGHTS	9 pcs
ADJUSTABLE NOZZLES	8 psc
JADE CHOPSTICK NOZZLES	1 pcs
SUBMESIBLE PUMPS	2 pcs
ELECTRICAL VALVE	2 pcs
PACKING SIZE	204 x 204 x 42 cm
GROSS WEIGHT	120 kg

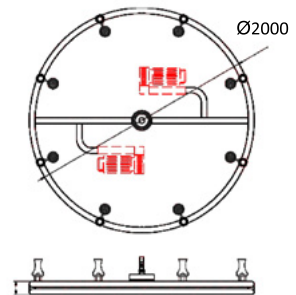

### DESIGN AQUA 14

#### ✓ Technical features

- Customised fountain sizes
- Water spray height: 0 – 10m
- Manufactured in AISI-304 stainless steel
- Iron or AISI-304 stainless steel submersible pump
- Plastic or AISI-304 stainless steel lamps
- RGB fountain lights
- Voltage: 110-220V 50/60Hz
- Built-in control to play with music pattern

#### Q Models

PRODUCT CODE	AQ14-4535
BODY SIZE	4.5 x 3.5 m
PUMP POWER	8 x 1.5 kW
WATER HEIGHT	6 m
LED LIGHTS	71 pcs
1/2" ADJUSTABLE NOZZLES	166 psc
J1.5" ADE CHOPSTICK NOZZLES	1 pcs
SUBMESIBLE PUMPS	8 pcs
ELECTRICAL VALVE	8 pcs
PACKING SIZE	210 x 210 x 30 cm
GROSS WEIGHT	250 kg

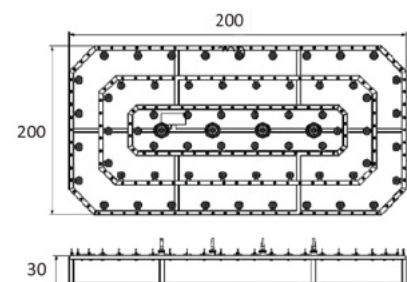
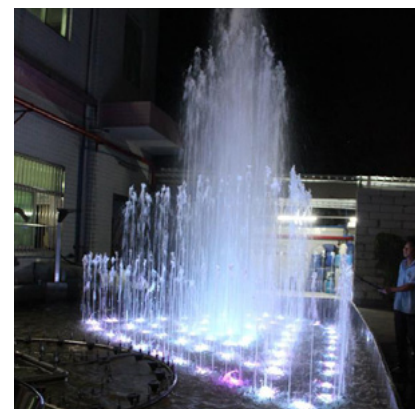

# FOUNTAIN NOZZLES 20/01

## FOUNTAINS

### DESIGN AQUA 15

#### Models

PRODUCT CODE	AQ15-4020
BODY DIAMETER	400X 200 cm
PUMP POWER	5 x 1.1 kW
WATER HEIGHT	5 m
LED LIGHTS	66 pcs
ADJUSTABLE NOZZLES	174 pcs
JADE CHOPSTICK NOZZLES	5 pcs
SUBMESIBLE PUMPS	5 pcs
ELECTRICAL VALVE	4 pcs
PACKING SIZE	404 x 204 x 42 cm
GROSS WEIGHT	490 kg

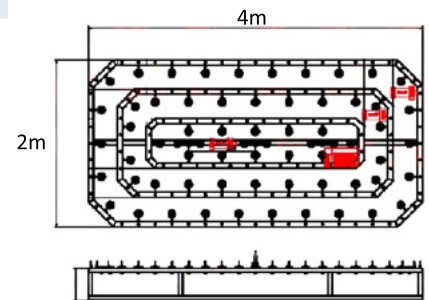

### DESIGN AQUA 16

#### Models

PRODUCT CODE	AQ16-4020
BODY DIAMETER "D"	4 x 2m
PUMP POWER	2 X 1.5 kW
WATER HEIGHT	5 m
LED LIGHTS	61 pcs
"1/2" ADJUSTABLE NOZZLES	114 pcs
"1" ADJUSTABLE NOZZLES	1 pcs
TOWER CEDAR NOZZLES	6 pcs
SUBMESIBLE PUMPS	2 pcs
ELECTRICAL VALVE	8 pcs
PACKING SIZE	404 x 204 x 42 cm
GROSS WEIGHT	140 kg

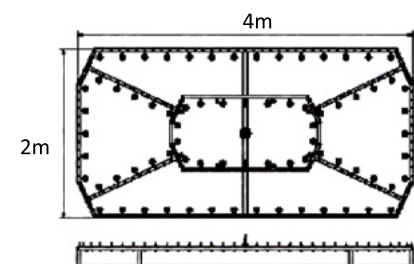
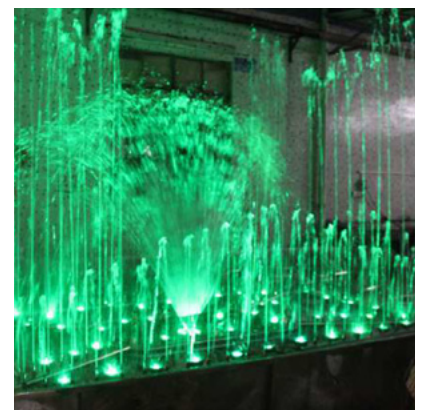



# FOUNTAIN NOZZLES 20/01

## FOUNTAINS

### DESIGN AQUA 17

#### Models

PRODUCT CODE	AQ17-2250
BODY SIZE	22 x 5 m
PUMP POWER	9 x 1.5 kW
WATER HEIGHT	10 m
LED LIGHTS	248 pcs
"1/2" ADJUSTABLE NOZZLES	256 pcs
"1/5" ADJUSTABLE NOZZLES	26 pcs
SUBMESIBLE PUMPS	9 pcs
ELECTRICAL VALVE	16 pcs
PACKING SIZE	2200 x 500 x 50 cm
GROSS WEIGHT	1000 kg

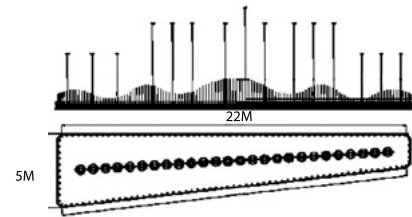

### DESIGN AQUA 18

#### Models

PRODUCT CODE	AQ18-1800
BODY DIAMETER	1.8m
PUMP POWER	1 x 1.5 kW
WATER HEIGHT	3 m
LED LIGHTS	13 pcs
"1/2" ADJUSTABLE NOZZLES	32 pcs
"1/5" ADJUSTABLE NOZZLES	1 pcs
SUBMESIBLE PUMPS	1 pcs
PACKING SIZE	184 x 184 x 42 cm
GROSS WEIGHT	80 kg

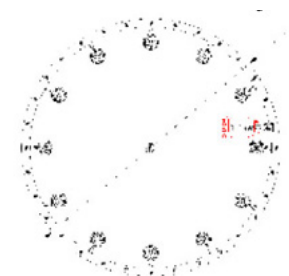
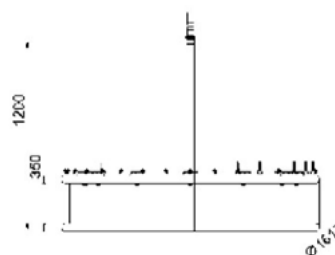
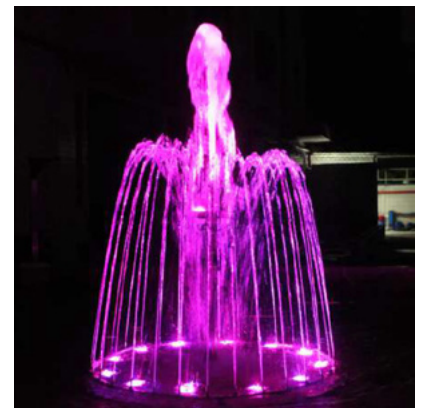

FOUNTAIN NOZZLES

# FOUNTAIN NOZZLES 20/01

## FOUNTAINS

### DESIGN AQUA 19

#### Q Models

PRODUCT CODE	AQ19-3000
BODY DIAMETER	3 m
PUMP POWER	6 x 1.1 kW
WATER HEIGHT	8 m
LED LIGHTS	49 pcs
"1/2" ADJUSTABLE NOZZLES	120 pcs
"1/5" ADJUSTABLE NOZZLES	1 pcs
CASCADE NOZZLE	4 pcs
SUBMESIBLE PUMPS	6 pcs
PACKING SIZE	304 x 154 x 80 cm
GROSS WEIGHT	220 kg

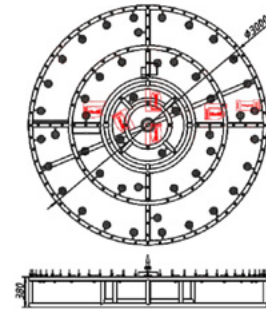

### DESIGN AQUA 20

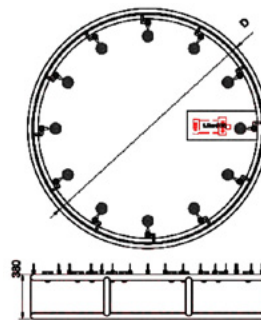

#### Q Models

PRODUCT CODE	AQ20-2000	AQ20-3000	AQ20-4000	AQ20-5000	AQ20-6000	AQ20-8000
BODY DIAMETER "D"	2 m	3 m	4 m	5 m	6 m	8 m
PUMP POWER	1 x 1.5 kW	1 x 2.2 kW	1 x 5.5 kW	2 x 4 kW	5 x 5.5 kW	4 x 5.5 kW
SWING MOTOR POWER	1 x 1.1 kW	1 x 1.1 kW	1 x 1.5 kW	1 x 2.2 kW	1 x 3 kW	4 x 4 kW
WATER HEIGHT	2.5 m	3.5 m	4.5 m	5.5 m	6.5 m	9 m
WATER COVER	Ø 7 m	Ø 10 m	Ø 13 m	Ø 16 m	Ø 19 m	Ø 26 m
DIRECT NOZZLES	25 pcs	38 pcs	42 pcs	53 pcs	63 pcs	72 pcs
LED LIGHTS	25 pcs	38 pcs	42 pcs	53 pcs	63 pcs	72 pcs
PACKING SIZE	204 x 204 x 40 cm	305 x 305 x 80 cm	405 x 405 x 80 cm	505 x 505 x 80 cm	605 x 605 x 80 cm	805 x 805 x 80 cm
GROSS WEIGHT	120 kg	180 kg	220 kg	260 kg	300 kg	380 kg

# FOUNTAIN NOZZLES 20/01

## FOUNTAINS

### DESIGN AQUA 21

#### ✓ Technical features

- Water height: 3m, 4m and 5m
- Manufactured in AISI-304 stainless steel
- RGB fountain lights
- Stainless steel or cast iron submersible pump
- AISI-304 stainless steel fountain nozzle
- With swing motor
- Voltage: 110V/220V/380V, 50/60Hz
- Packing: wood frame

#### 🔍 Models

PRODUCT CODE	AQ21-2000	AQ21-3000	AQ21-4000
BODY SIZE	200 x 30 cm	300 x 30 cm	400 x 30 cm
PUMP POWER	1 x 1.5 kw	1 x 2.2 kw	1 x 5.5 kw
SWING MOTOR POWER	1 x 1.1 kw	1 x 1.5 kw	1 x 2.2 kw
WATER HEIGHT	3 m	4 m	5 m
WATER COVER DIAMETER	6 m	8 m	10 m
DIRECT NOZZLES	20 pcs	30 pcs	38 pcs
LED LIGHTS	20 pcs	30 pcs	38 pcs
PACKING SIZE	204 x 34 x 40 cm	304 x 34 x 40 cm	404 x 34 x 40 cm
GROSS WEIGHT	80 kg	90 kg	120 kg

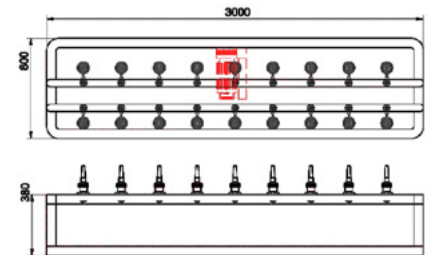

### CONTROLLER

#### 🔍 Models

PRODUCT CODE	JFC-001
VOLTAGE	220V
SIZE	550 W
FEATURE	CAN CONTROL A SERIES JUMPING
PACKING SIZE	25 x 25 x 25 cm
GROSS WEIGHT	15 kg





Your global partner since 1974. Trusted for superior quality and exceptional innovations.



## Head Office

### AQUA S.p.A

42018 San Martino in Rio, Reggio Emilia  
Italy - Via Crotti, 1  
P: +39 0522 695805/85 - F: +39 0522 646160  
aqua@aqua.it | www.aqua.it

### AQUA S.p.A - POOL DIVISION

46043 Castiglione d. Stiviere, Mantova - Italy  
P: +39 0376 671973 - F: +39 0376 940139  
infopools@aqua.it | www.aqua.it



## Branches

### AQUA WATER SYSTEMS LTD

Unit 135 Oak Drive Hartlebury Trading Estate,  
Worcestershire, DY10 4JB  
P: +44 (0)1299 251050, F: +44 (0)1299 253704  
sales@askaqua.co.uk | www.askaqua.co.uk

### AQUA FILTRACION S.A.

Pol. Ind. Castellbisbal Sud 08755  
Castellbisbal, Barcelona  
P: +34 (0)93 7711855, F: +34 (0)93 7711772  
info@aqua.es | www.aqua.es

### AQUA SU ARITIMI SAN. VE MUH. TIC. LTD. STI.

Ferhatpasa Mahallesi Maresal Fevzi Cakmak  
Cad. No:45 Pk.34888 Atasehir / Istanbul - Turkey  
P: +90 216 661 60 60, F: +90 216 661 68 50  
info@aqua.com.tr | www.aqua.com.tr

### AQUA MIDDLE EAST FZC

1J-07/4 and 1J-07/3 - Hamriyah Free Zone  
P.O.Box 42585 Sharjah - United Arab Emirates  
P: +971 6 526 0563, F: +971 6 526 0564  
contact@aqua-me.ae  
www.aqua-me.ae

### AQUA WATER SYSTEMS INDIA PVT LTD

4A/4B/4C-,Puttappa Industrial Estate  
Mahadevapura Post, White Field Road,  
Bangalore 560 048  
P: 0091 80 4152 1313, F: 0091 80 4152 1414  
contact@aquaindia.in | sales@aquaindia.in  
www.aquaindia.in

### AQUA GROUP RUS

Juridical Address:  
107014, Egerskaya str, 1, Moscow, Russia  
Residence Address:  
127081, Chermianskaya str, 3, Moscow, Russia  
P: +7 495 6458078, F: +7 495 969 2413  
mail@aqua-italy.ru | www.aqua-italy.ru  
www.aqua.it

### AQUA GROUP LLC

Office : Regus – Sarayat EL Maadi, Egypt  
Management & Warehouse : Plot no 2-2nd service  
axe, 2nd Industrial Zone, October, Egypt  
P: +20 2 3820 2259 | info@aqua.eg