

# STEAM GENERATOR



## STEAM GENERATOR STANDARD

A new generation steam generator with a host of advanced features including top quality Teflon coated, incoloy elements that resist scaling, and combined with additional electronics for a long trouble-free working life. All generators feature an advanced electronic control panel with on-board diagnostics, displaying a series of LEDs to show each operation of the boiler.

The generator is fitted with several heating elements that operate sequentially. From cold, all elements operate for rapid heating. When the steam room temperature is achieved, a number of the elements drop out, whilst the others alternate on and off to gently maintain the

temperature without large fluctuations, to improve user comfort. All generators feature an auto drain-down system with a self-flushing cycle to dump the boiler contents in a controlled manner. At the end of each steaming session, the generator will stop for a few minutes to allow the water to cool a little. The drain valve will then open and after a short time, the cold water inlet valve will open to give a period of continuous flushing and draining to reduce the build-up of damaging limescale. Cooling the elements before the final drainage helps prolong their useful life.

## ✓ Technical features

- Extra heavy duty and robust system
- Electronic controls with a digital display to enable temperatures of 30 to 60°C
- Duration: 15 to 240 minutes or continual operation
- Additional keys for a steam room light, keyboard lock, manual drain down etc.
- Steam inlet nozzle with facility for adding essential oils
- Safety features include boil dry protection thermal overload safety cut out and pressure relief valve
- All steam generators comes with the steam inlet, on-demand steam button, intelligent digital controller, pressure relief valve and auto descaling system
- Frequency: 50/60 Hz

**Please note:** For the commercial use of steam generators, we strongly recommend the use of softened water to reduce the build-up of limescale and easier maintenance. For additional fragrance injection please order an essence dosing kit.

## 📏 Dimensions

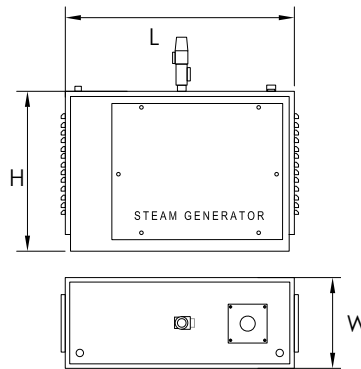

**TOUCH CONTROL PANEL**  
(Add 'x' at the end of the item code)



**SWITCH**



**CONTROL PANEL**

## 🔍 Models

PRODUCT CODE	POWER kW	VOLTAGE V	PHASE N~	CURRENT A	Recommended steam room m <sup>3</sup>	DIMENSIONS mm			PKG	WEIGHT kg	VOLUME m <sup>3</sup>
						L	w	H			
SG-30	3.0	230	1	13	1.5-3	530	180	330	1	18.00	0.03
SG-40	4.0	230	1	17	1.8-4	530	180	330	1	19.25	0.03
SG-45	4.5	230/400	1/3	19.5/6.5	1.8-5	530	180	330	1	19.50	0.03
SG-60	6.0	230/400	1/3	26.4/8.7	4-6	530	180	330	1	19.75	0.03
SG-80	8.0	230/400	1/3	34.8/13	5-9	530	210	370	1	20.00	0.03
SG-90	9.0	230/400	1/3	39/13	6-10	530	210	370	1	20.25	0.03
SG-105	10.5	230/400	1/3	43.5/15	7-11	530	210	370	1	20.50	0.03
SG-120	12.0	230/400	1/3	52/17	8-12	530	210	370	1	20.75	0.03
SG-135	13.5	230/400	1/3	59/19.5	11-16	530	210	370	1	21.00	0.03
SG-150	15.0	230/400	1/3	65/21.7	11-16	530	210	370	1	21.25	0.03
SG-180	18.0	230/400	1/3	78/26	13-19	530	210	370	1	21.25	0.03
SG-30X	3.0	230	1	13	1.5-3	530	180	330	1	18.00	0.03
SG-40X	4.0	230	1	17	1.8-4	530	180	330	1	19.25	0.03
SG-45X	4.5	230/400	1/3	19.5/6.5	1.8-5	530	180	330	1	19.50	0.03
SG-60X	6.0	230/400	1/3	26.4/8.7	4-6	530	180	330	1	19.75	0.03
SG-80X	8.0	230/400	1/3	34.8/13	5-9	530	210	370	1	20.00	0.03
SG-90X	9.0	230/400	1/3	39/13	6-10	530	210	370	1	20.25	0.03
SG-105X	10.5	230/400	1/3	43.5/15	7-11	530	210	370	1	20.50	0.03
SG-120X	12.0	230/400	1/3	52/17	8-12	530	210	370	1	20.75	0.03
SG-135X	13.5	230/400	1/3	59/19.5	11-16	530	210	370	1	21.00	0.03
SG-150X	15.0	230/400	1/3	65/21.7	11-16	530	210	370	1	21.25	0.03
SG-180X	18.0	230/400	1/3	78/26	13-19	530	210	370	1	21.25	0.03

# STEAM GENERATOR PREMIUM

## ✓ Technical features

- Programmable timer (daily and weekly) for steam production and temperature settings to accommodate different users
- Input for two probes, averaged to equalise the temperature of the cabin
- Management of 3 pumps for different, user-selectable essences
- Management of 4th specific pump for an automatic programmable sanitization cycle
- Management of fans (intake and exhaust) and cabin light
- The control display can be mounted at a considerable distance (out of technical closet but not inside the steam cabin)
- Multi-lingual user interface
- Setup WIZARD at first switch-on
- Range: 1.5 to 65 kg/h
- Large alphanumeric/graphic display (8 lines of text)
- State-of-the-art control pCO family (ON/OFF, Proportional, regulating with 1 or 2 probes)
- Signals: 0-1V, 0-10V, 0-20mA, 4-20mA, 0-135 Ohm
- Cylinder lifetime counter
- 0-10V output for controlling a slave unit
- Diagnostics with time-stamping
- Alarm relay and "status" relay
- Standard connectivity: Modbus
- Automatic drain for inactivity
- Wooden cup connected to a pipe to put the water on top of the heater



## 📏 Dimensions

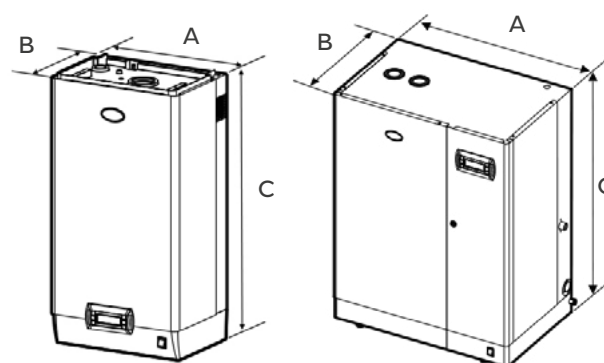

### EASY OPERATION

Backlit LCD for clear understanding of unit operating status and Diagnostics



### HYGIENE

The water is drained Automatically when the unit is Inactive for a certain period of time, avoiding stagnation

## 🔍 Models

PRODUCT CODE	POWER kW	STEAM KG/H	VOLTAGE V	PHASE N~	RECOMMENDED STEAM ROOM m <sup>3</sup>	DIMENSIONS mm			PACKING	WEIGHT kg	VOLUME m <sup>3</sup>
						A	B	C			
UE001WDC01	1.2	1	230	1	1-2	365	275	712	1	16	0.071
UE003WDC01	2.25	3	230	1	2-3	365	275	712	1	16	0.071
UE005WDC01	3.75	5	230	1	3-4	365	275	712	1	16	0.071
UE009WDC01	6.75	9	230	1	4-7	365	275	712	1	20	0.071
UE003WLC01	2.25	3	400	3	2-3	365	275	712	1	20	0.071
UE005WLC01	3.75	5	400	3	3-4	365	275	712	1	20	0.071
UE010WLC01	7.5	10	400	3	4-8	365	275	712	1	20	0.071
UE015WLC01	11.25	15	400	3	8-12	365	275	712	1	20	0.071
UE018WLC01	13.5	18	400	3	12-14	365	275	712	1	20	0.071
UE025WLC01	18.75	25	400	3	14-19	545	375	465	1	39	0.095
UE035WLC01	26.25	35	400	3	19-26	545	375	465	1	39	0.095
UE045WLC01	33.75	45	400	3	26-34	635	465	890	1	51	0.095
UE065WLC01	48.75	65	400	3	34-48	635	465	890	1	51	0.095

## STEAM GENERATOR ACCESSORIES



### RUBBER HOSE

**1312360AXX:** 22mm for steam kg/hr 1.5 (4pcs each)  
**1312365AXX:** 30mm for steam kg/hr 3, 5, 9, 10, 15, AND 18 (4pcs each)  
**1312367AXX:** 40mm for steam kg/hr 25,35,45 (4pcs each) and 65KG/HR (8pcs each)



### TEMP.SENSOR

**DPWC110000 :** 10T60GR.C. (OUT 0-1V DC - 4-20MA) / Humidity RH 10- 90% (OUT 0-1V DC - 4-20MA) for steam kg/hr 1.5, 3, 5, 9, 10, 15, 18, 25, 35, 45 and 65 (1pc each)



### DISTRIBUTORE VAPORE SERIE DP INOX

**DP035D22R0:** L=350mm, Ø 22mm for steam kg/hr 1.5 and 3 (1pc each)  
**DP035D30R0:** L=350mm, Ø 30mm for steam kg/hr 5 (1pc each)  
**DP060D30R0:** L=600mm, Ø 30mm for steam kg/hr 9 and 10 (1pc each)  
**DP085D30R0:** L=850mm, Ø 30mm for steam kg/hr 15 and 18 (1pc each)  
**DP085D40R0:** L=850mm, Ø 40mm for steam kg/hr 25 (1pc each)  
**DP105D40R0:** L=1050mm, Ø 40mm for steam kg/hr 35 (1pc each) 65 (2pcs each)  
**DP125D40R0:** STAINLESS STEEL STEAM DISTRIBUTOR, L=1250mm, Ø 40mm for steam kg/hr 45 (1pc each)



### WATER HOSE

**FWH3415003:** Flexible water hose kit 3/4" 1.5MT – with plastic sheet for steam kg/hr 1.5, 3, 5, 9, 10, 15, and 18 (1pc each)  
**1312368AXX:** Air/Water 15 Bar Ø 9.5mm for steam kg/hr 25, 35, and 45 (4pcs each) and 65 (8pcs)

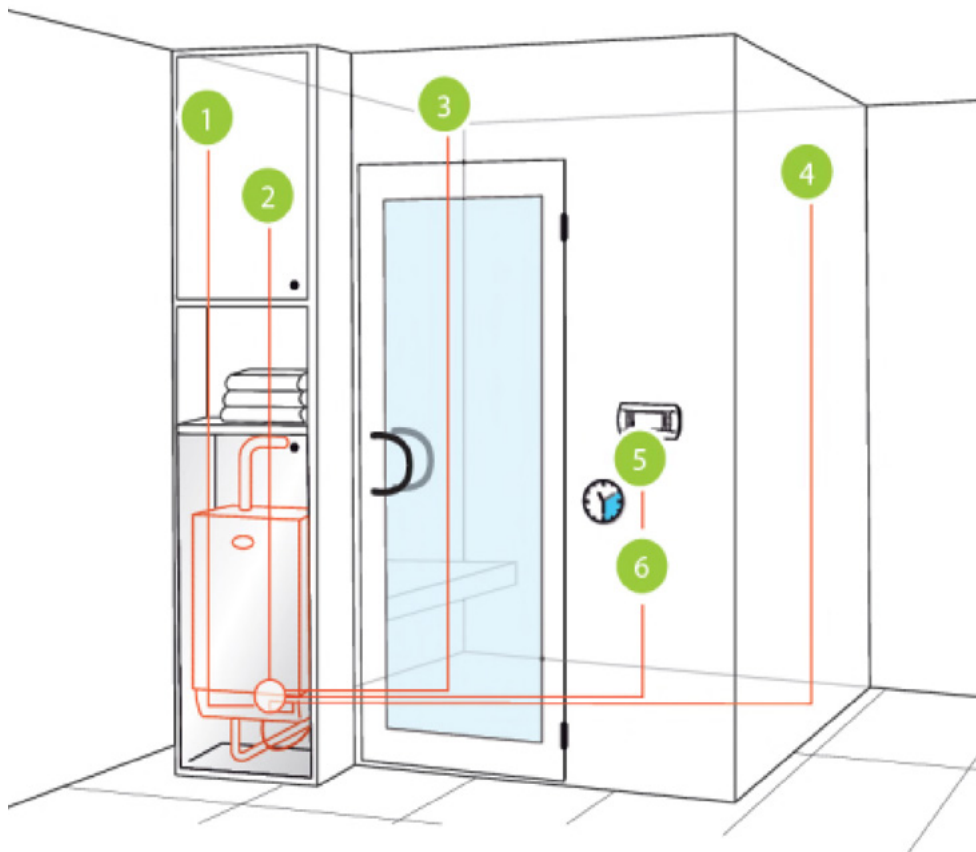

1 Cleaning and disinfecting control

2 Essence control

3 Light control

4 Fan control

5 Remote control display

6 Clock programming function



Your global partner since 1974. Trusted for superior quality and exceptional innovations.



## Head Office

### AQUA S.p.A

42018 San Martino in Rio, Reggio Emilia  
Italy - Via Crotti, 1  
P: +39 0522 695805/85 - F: +39 0522 646160  
aqua@aqua.it | www.aqua.it



## Branches

### AQUA WATER SYSTEMS LTD

Unit 135 Oak Drive Hartlebury Trading Estate,  
Worcestershire, DY10 4JB  
P: +44 (0)1299 251050, F: +44 (0)1299 253704  
sales@askaqua.co.uk | www.askaqua.co.uk

### AQUA FILTRACION S.A.

Pol. Ind. Castellbisbal Sud 08755  
Castellbisbal, Barcelona  
P: +34 (0)93 7711855, F: +34 (0)93 7711772  
info@aqua.es | www.aqua.es

### AQUA SU ARITIMI SAN. VE MUH. TIC. LTD. STI.

Ferhatpasa Mahallesi Maresal Fevzi Cakmak  
Cad. No:45 Pk.34888 Atasehir / Istanbul - Turkey  
P: +90 216 661 60 60, F: +90 216 661 68 50  
info@aqua.com.tr | www.aqua.com.tr

### AQUA S.p.A - POOL DIVISION

46043 Castiglione d. Stiviere, Mantova - Italy  
P: +39 0376 671973 - F: +39 0376 940139  
infpools@aqua.it | www.aqua.it

### AQUA MIDDLE EAST FZC

1J-07/4 and 1J-07/3 - Hamriyah Free Zone  
P.O.Box 42585 Sharjah - United Arab Emirates  
P: +971 6 526 0563, F: +971 6 526 0564  
contact@aqua-me.ae  
www.aqua-me.ae

### AQUA WATER SYSTEMS INDIA PVT LTD

4A/4B/4C-,Puttappa Industrial Estate  
Mahadevapura Post, White Field Road,  
Bangalore 560 048  
P: 0091 80 4152 1313, F: 0091 80 4152 1414  
contact@aquaindia.in | sales@aquaindia.in  
www.aquaindia.in

### AQUA GROUP RUS

Juridical Address:  
107014, Egerskaya str, 1, Moscow, Russia  
Residence Address:  
127081, Chermianskaya str, 3, Moscow, Russia  
P: +7 495 6458078, F: +7 495 969 2413  
mail@aqua-italy.ru | www.aqua-italy-ru  
www.aqua.it

### AQUA GROUP LLC

Office : Regus – Sarayat EL Maadi, Egypt  
Management & Warehouse : Plot no 2-2nd service  
axe, 2nd Industrial Zone, October, Egypt  
P: +20 2 3820 2259 | info@aqua.eg

